

North-east Elevation 1:20

Broxap Wardale cycle shelter. Hot dip galvanised and finished in colour to be chosen by client

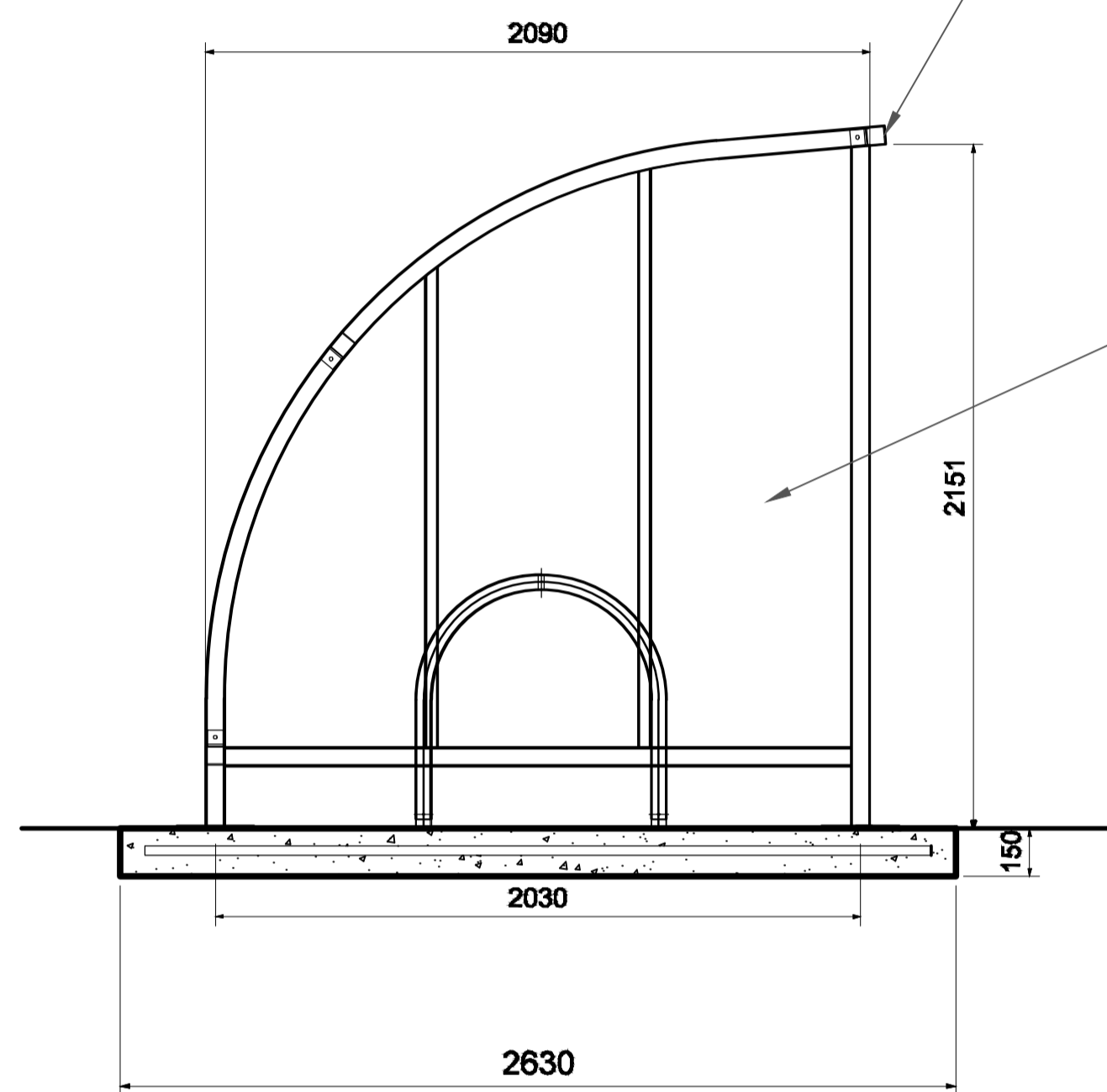

North-west Elevation 1:20

Transparent 4mm PETG uv cladding.

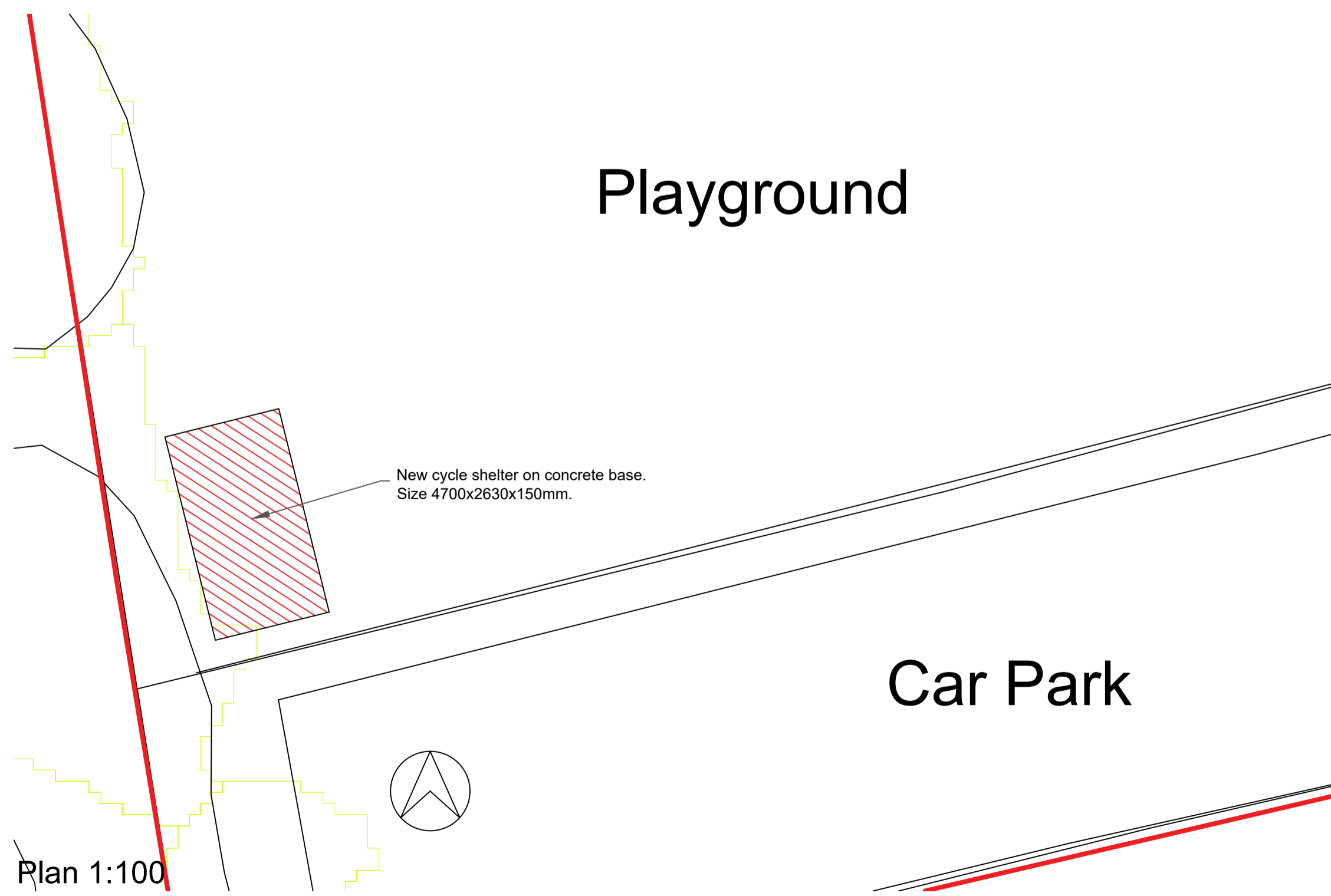

Plan 1:100

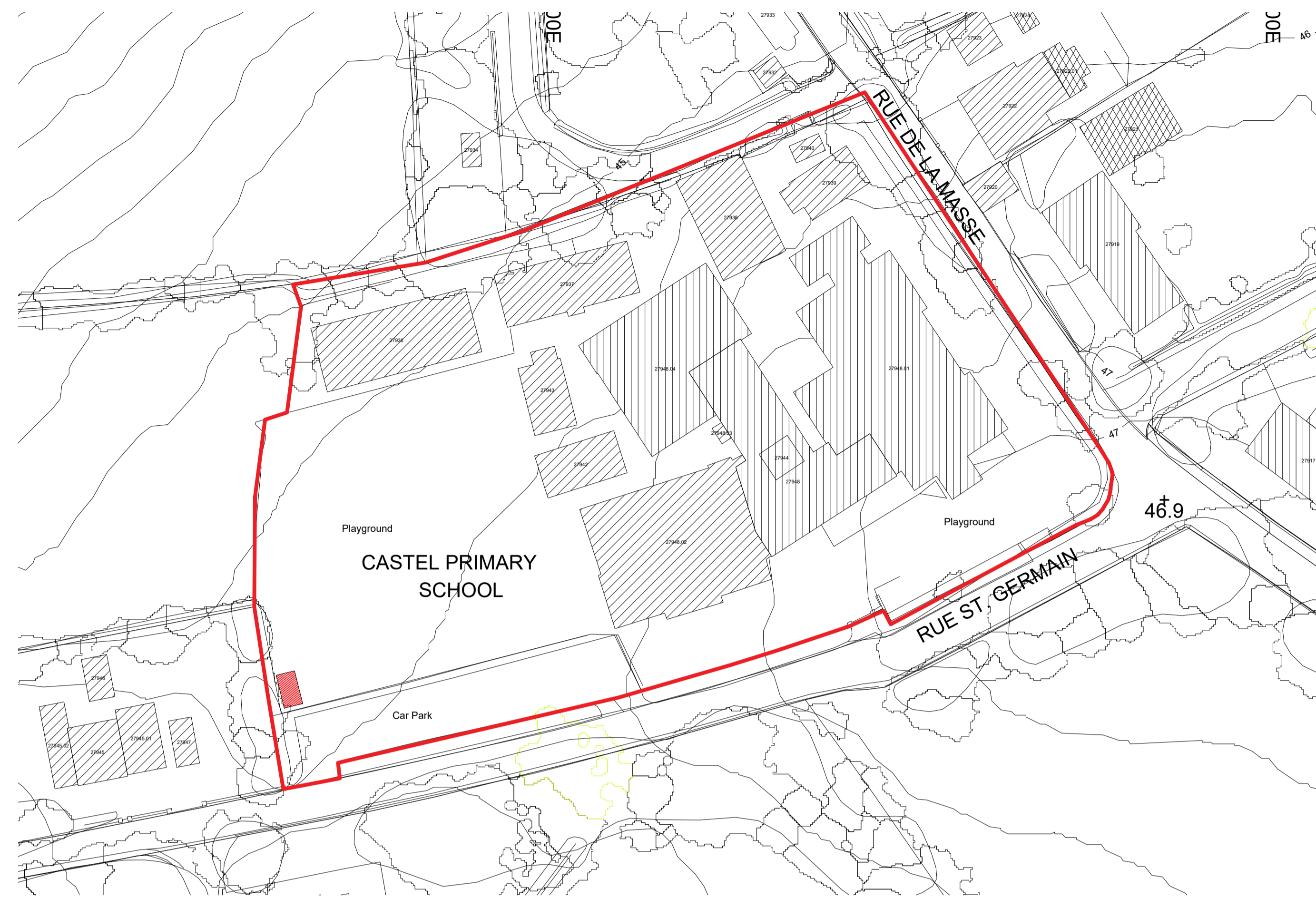

Block Plan 1:500

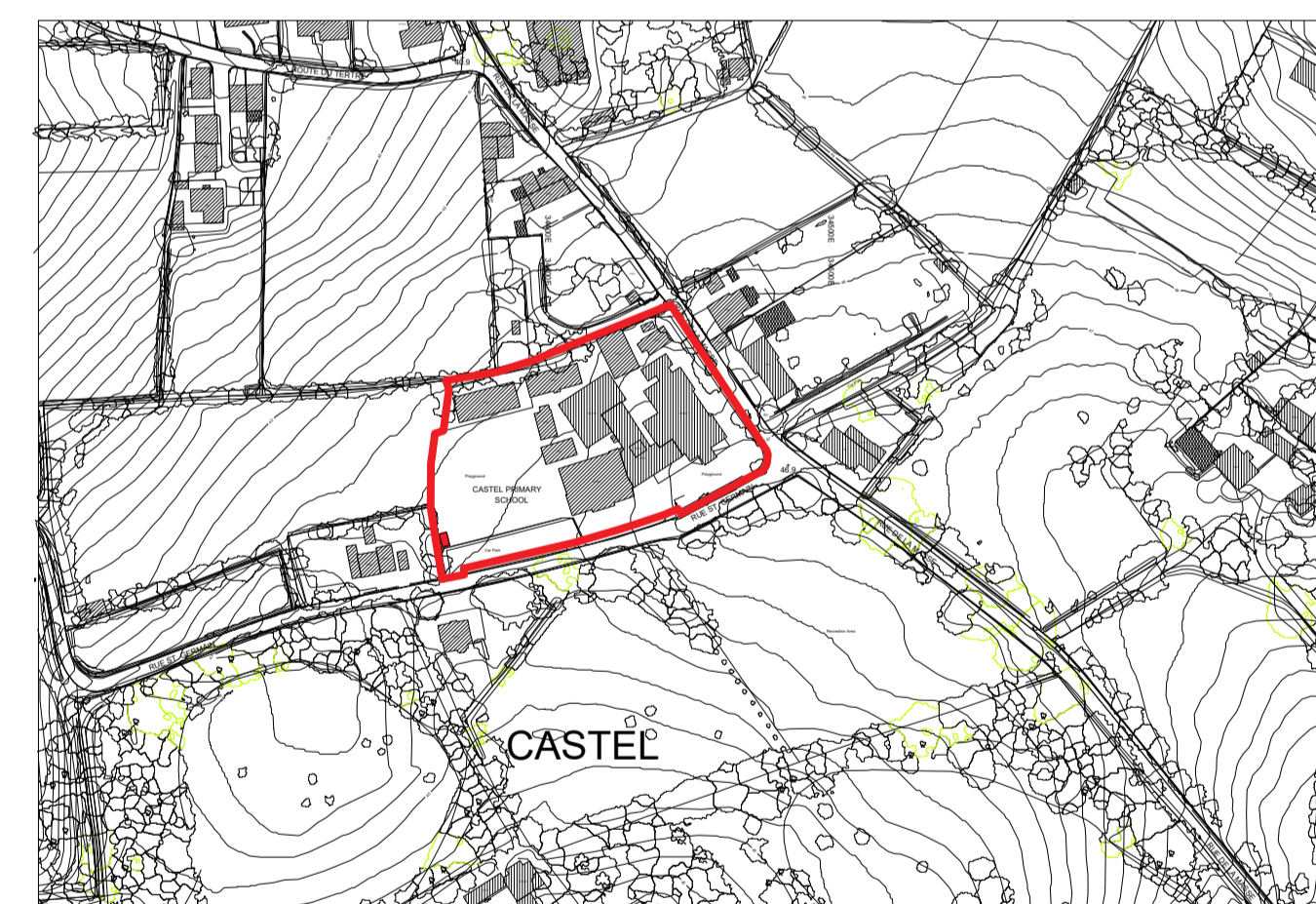

Location Plan 1:2500



NOTES:
ALL DIMENSIONS ARE STRUCTURAL. FIGURED DIMENSIONS TO BE USED IN PREFERENCE TO SCALED DIMENSIONS. CHECK ALL DIMENSIONS ON SITE. ANY DISCREPANCIES BETWEEN THIS DRAWING AND SITE CONDITIONS MUST BE REFERRED TO PROPERTY SERVICES

Shelter supplied by:-

Broxap Ltd.
Head Office
Rowhurst Industrial Estate,
Chesterton,
Newcastle-under-Lyme,
ST5 6BD
United Kingdom

web - www.broxap.com

Original Dimension = 100mm

| Revisions | Dr'n | Ch'd | Date |
|-----------|------|------|------|
| | | | |
| | | | |
| | | | |

Status
Planning application

States of Guernsey
Property Services
Head of Project Services: Graeme Falla
MA, CEng, CEnv, M.I.C.E.
Sir Charles Frossard House, St Peter Port, Guernsey
Tel: 01481 717000 Email: property@gov.gg

Project Manager: **James O'Reilly**

Client: **Office of the Committee for Education, Sport & Culture**

Project:
New cycle shelter
Castel Primary School
La Route de St. Germain
Castel
GY5 7PH

Title:
Planning application drawing
Plans and elevations

| | |
|-----------------------------|---------------------------|
| PS Reference No: 0118EC0 | Cadastre No: D01099000 |
|-----------------------------|---------------------------|

| | |
|------------------------|------------------|
| Drawing Number: P01 | Revision: - - |
|------------------------|------------------|

| | |
|-------------------------|-------------------|
| Scale @ A1: as noted | Date: Dec 2020 |
|-------------------------|-------------------|

| | |
|-----------------|-------------------|
| Drawn by: PH | Checked by: DA |
|-----------------|-------------------|