

Proposed
10x12' shed

THIS DRAWING IS COPYRIGHT

This document and its design content is copyright ©. It shall be read in conjunction with all other associated project information including models, specifications, schedules and related consultants documents. Do not scale from documents. All dimensions to be checked on site. Immediately report any discrepancies, errors or omissions on this document to the Originator. If in doubt ASK.

100mm at original scale

ASBESTOS CONTAINING MATERIALS
Due to age and type of building Asbestos Containing Materials may be present. Contractor to undertake R & D Asbestos survey in areas to have works undertaken to ascertain risk.

THE CONTRACTOR & HIS SUB-CONTRACTORS ARE TO VERIFY ALL DIMENSIONS ON SITE BEFORE MAKING SHOP DRAWINGS OR COMMENCING MANUFACTURE

SETTING OUT OF BUILDING WORKS
Figured dimensions to be used in preference to scaled dimensions. Structural grid/overall layout to be set out on site 100% prior to the commencement of building operations.

In addition to the hazard/risks normally associated with the types of work detailed on this drawing take note of the above. It is assumed that all works on this drawing will be carried out by a competent contractor working, where appropriate, to an appropriate method statement.

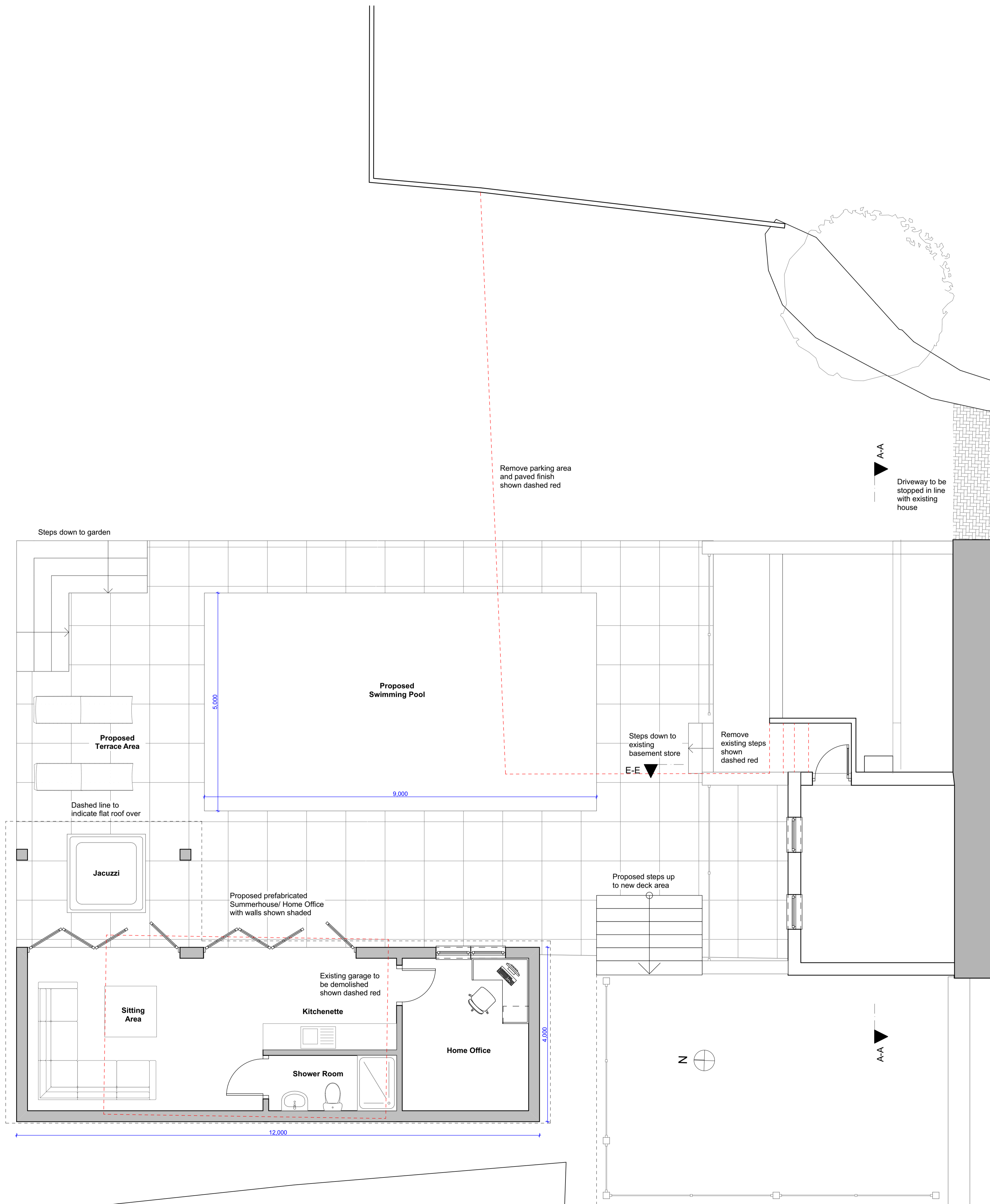

| | |
|---|------------------|
| Purpose of Issue PLANNING | Work Stage 03 |
| | |
| <small>Grey Bear Ltd. No 2 Northumberland House, La Roche Road, Vale, Guernsey GY9 5DF T: 07931 766 731 enquiries@greybear.co.uk www.greybear.co.uk</small> | |
| Project Ormer House La Grande Rue, St Saviours, Guernsey | |
| Client Mr & Mrs Wyatt | |
| Layout Title Site Plan | |
| Drawing Number 102-3-301 | |
| Drawn by ELC | |
| Revision | |