

South Elevation

1:100

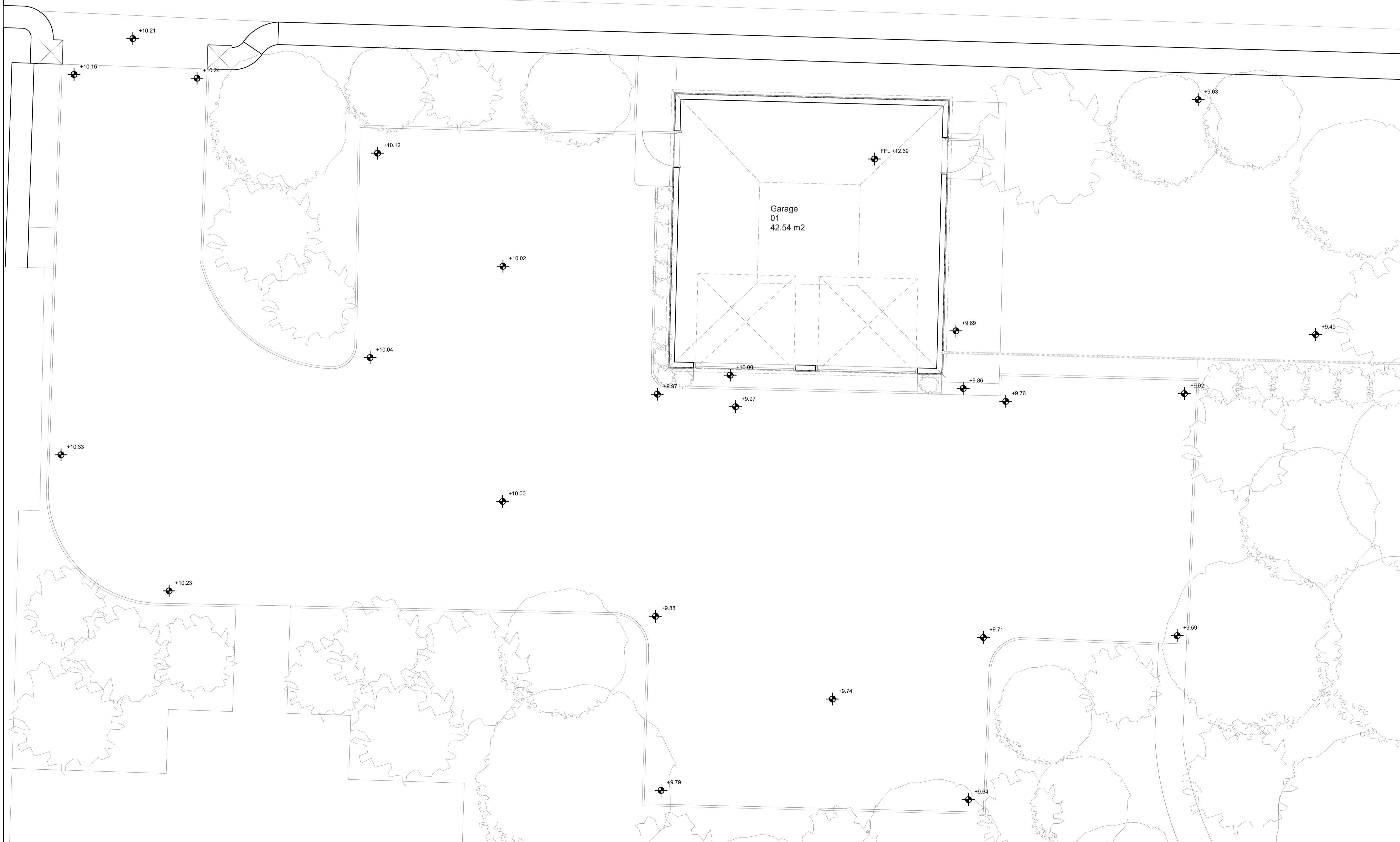

Ground Floor Plan

notes

THE CONTRACTOR & HIS SUB-CONTRACTORS ARE TO VERIFY ALL DIMENSIONS ON SITE BEFORE MAKING SHOP DRAWINGS OR COMMENCING MANUFACTURE

Figured dimensions to be used in preference to scaled dimensions. contractors must check all dimensions on site. Any discrepancies discovered between this drawing and site conditions must be referred to the architect immediately. Setting out of building works. IMPORTANT - structural grid/overall layout to be set out on site 100% prior to the commencement of building operations.

THIS DRAWING IS COPYRIGHT

100mm at original scale

Drawing Status

Preliminary  Building Control  As Built   
 Planning  Construction  Other

Proposed alterations and extensions to:  
 Le Hurel House  
 Le Vallon, St Martins, Guernsey, GY4 6DQ  
 for Mr & Mrs R Clark

MEASURED SURVEY  
 Floor Plan & Elevation

**create.**

chartered architects | chartered surveyors

Create Limited - Shoreline House - Marion Place -  
 Port Grat - St. Sampson - Guernsey - GY2 4TD

T: +44 (0) 1481 259333

E: info@create-architecture.com  
 W: www.create-architecture.com

scale @A1 1:50, 1:100	drawn by HF	checked by	date NOV 2020
Drawing No. <b>923-1-002</b>		Revision	
This drawing is copyright of Create Ltd. and is licensed to the client only for the purposes related to the RIBA work stages listed only. No other use is permitted without the architects express permission.			RIBA work stage <b>1</b>

1:50